

VULCAFLOR

Substrate in accordance to UNI 11235 standard green cover

VOLCANIC SUBSTRATE FOR GREEN ROOFS, URBAN AND VERTICAL GREEN PLANTS

COMPOSITION VULCAFLOR INTENSIVE:

It is a fertile soil consisting of the mixture of volcanic materials (pumice and lapillus, approx. 70% of which are volcanic lapillus and 30% pumice with a grain size of 0-10 mm), organic substances (like blond peat of medium grain size) and/or organic substances with humus (like vegetable compost material) and complex fertilizers with nitrogen in form of controlled transfer.

COMPOSITION VULCAFLOR EXTENSIVE:

It is a fertile soil consisting of the mixture of volcanic materials (pumice and lapillus, approx. 90% of which are volcanic lapillus and 10% pumice with a grain size of 0-10 mm), organic substances like blond peat of medium grain size.

COMPOSITION VULCAFLOR LIGHT:

It is a fertile soil consisting of the mixture of volcanic materials (pumice and lapillus, approx. 20% of which are volcanic lapillus and 80% pumice with a grain size of 3-7 mm), organic substances (like blond peat of medium grain size) and/or organic substances with humus (like vegetable compost material) and complex fertilizers with nitrogen in form of controlled transfer.

APPLICATION FIELDS:

- Grass carpets
- Hanging gardens
- Urban arrangements
- Vertical green plants
- Management and maintenance of green plants

PHYSICAL AND CHEMICAL PROPERTIES:

- Specific weight: V. Intensive and V. Extensive 950 - 1050 Kg/m³ (humidity of the quarry); V. Light 700 - 800 Kg/m³ (humidity of the quarry)
- Material weight, water saturated : 1.300 Kg/m³
- Grain size: between 0 to 10 mm
- Permeability: higher than 0,6 mm/min. saturated and compressed; more than 6 mm/min. under normal conditions (DIN: >0,4 e >1 mm/min.)
- Water retention (available/utilised water): from 15% to 20 % in volume for Vulcaflor intensive, from 9% to 15% for the extensive one
- pH: between 7 and 8
- Organic substances: 15 % for Vulcaflor intensive, 8% for Vulcaflor extensive
- C.S.C.: approx. 30 meq/100g for Vulcaflor intensive, approx. 20 meq/100g for Vulcaflor extensive
- Active limestone free
- Chemical composition: see table below

MEDIUM CHEMICAL ANALYSIS	PUMICE	LAPILLUS
SiO ₂	62,5 %	56 %
Al ₂ O ₃	17,5 %	16,5 %
K ₂ O	9,5 %	4,9 %
Fe ₂ O ₃	2,6 %	6,5 %
CaO	2,5 %	8,8 %
Na ₂ O	2,2 %	2,2 %
TiO ₂	0,5 %	0,8 %
MgO	0,4 %	3,1 %
PH	7-8	7-8

FUNCTIONAL PROPERTIES:

VULCAFLOR is a finished product, soft textured, free from toxic or dangerous substances and weed seeds. **VULCAFLOR** is an ideal substrate for the construction of green roofs, flower boxes and every type of realization in the green where a reduced intervention of maintenance is required. **VULCAFLOR** intensive forms a fertile root layer for the essences of green gardening. **VULCAFLOR** extensive is an ideal substrate for the construction of green roofs of the extensive type with reduced thickness, available load bearing capacity of the attic (100-200 kg/mq) and lawn with plant essences with reduced water and nutritional needs. **VULCAFLOR LIGHT** is a light substrate ideal for the pump in the construction of green roofs.

CONSTRUCTION PLANS FOR ROOF GREENING WITH VULCAFLOR

The different stratifications of materials, indicated on these draft schemes, are based on the aim of (extensive and intensive) greening and of sustainability of the covering. The materials can be used for realization once the FINAL IMPERMEABILIZATION has been performed.

Some instructions:

- Vulcaflor is advantageous over the root resistant panel of fabric, however not necessary, to place a three-dimensional net like Enkamat with bi-coupled TNT, with a protecting function of the fabric, with a dot-like load distribution, and useful to create an empty draining layer between the substrate and the waterproofing.
- Between the drainage layer and the Vulcaflor can be spaced an anchor net for the roots (shading type to 90%)
- The solutions of EXTENSIVE type don't need irrigation, however for the solution of INTENSIVE type it is necessary to set up an irrigation equipment suitable for any vegetation.

USEFUL RANGE 150-250 Kg/mq

INTENSIVE

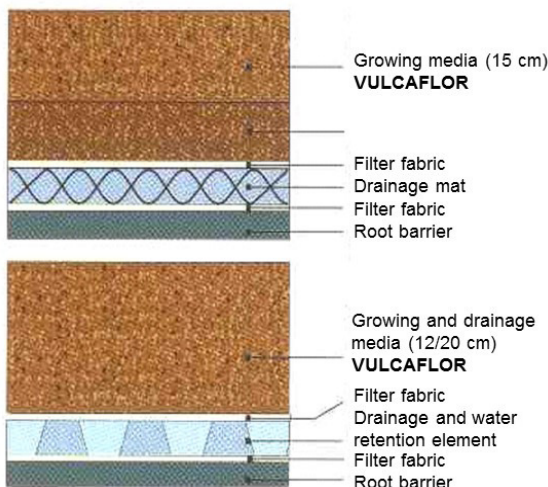

USEFUL RANGE 100 Kg/mq

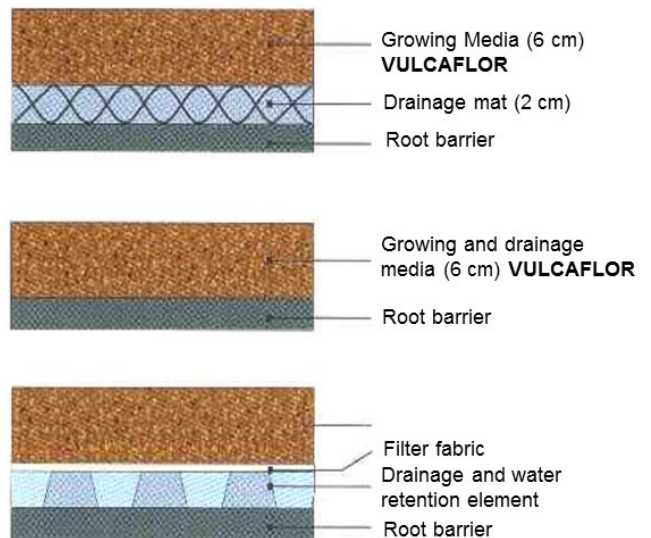

USEFUL RANGE 100-200 Kg/mq

EXTENSIVE (Sedum – moss)

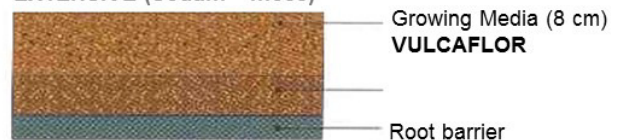

EXTENSIVE AND SEMI-EXTENSIVE

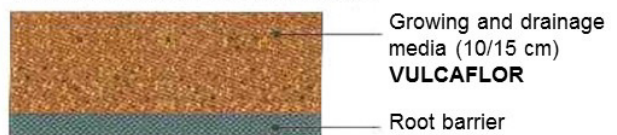

SEMI-EXTENSIVE AND INTENSIVE

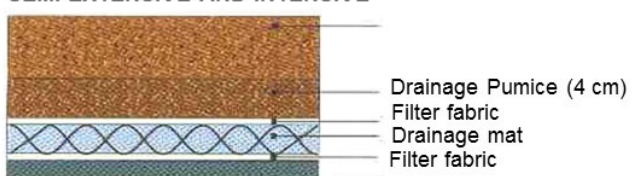

This mineral is a natural raw material. All data indicated above are therefore approximate and do not provide any warranty.

AVAILABLE UNPACKED, IN BAGS (BIG-BAGS) 1,5MC SIZE AND IN 33LT BAGS PACKED ON PALLETS (45 bags on each pallet).